

**CRIS ENTERPRISES, INC. – FAMILY GRAIN MILL® SYSTEM
LIMITED WARRANTY 5 year warranty**

Should any manufacturing defect be discovered, Cris Enterprises, Inc. agrees to repair or replace the defective product or part at their expense, other than handling and return freight charges, provided The Family Flaker Mill attachment is returned with shipping charges prepaid.

This warranty is for the original purchaser and is for normal home use only. This warranty is non-transferable.

This warranty does not apply to any unit that has been tampered with or to damage incurred through negligence, misuse, faulty packing or mishandling in transit by any common carrier or by damage caused by foreign objects used before, during or after the milling process. Unclean grain sometimes will contain rock and/or metal objects, which can cause damage to your mill. Always use quality, clean grains. Never grind POPCORN.

Upon receipt of you mill and attachments inspect all attachments for parts.

Report any missing pieces within two week of receipt of mill. Cris Enterprises, Inc. will not replace any missing parts after two week of receipt of mill.

NOTE: The warranty given by CRIS DOES NOT APPLY to the appearance of any Product or to any Product which has been subjected to misuse, mishandling or service by any unapproved service person or to any Product which has been damaged, defaced, modified, altered or tampered with, whether externally or internally or to any product sold or used outside United States of America or Canada.

The SOLE AND EXCLUSIVE REMEDY under this warranty is REPAIR OR REPLACEMENT AT CRIS'S OPTION of any Product that proves to be defective in manufacture or materials within the 5 years period from the date of purchase. TO THE FULLEST EXTENT PERMITTED BY LAW, CRIS DISCLAIMS ALL LIABILITY FOR ANY OTHER DIRECT, INCIDENTAL OR CONSEQUENTIAL DAMAGES ALLEGED TO BE CAUSED BY A DEFECTIVE PRODUCT, IE. CRIS WILL NOT BE RESPONSIBLE FOR ANY PERSONAL INJURY, PROPERTY DAMAGE OTHER THAN THE COST OF REPLACING THE PRODUCT OR ANY OTHER MONETARY DAMAGES SUCH AS LOST WAGES OR PROFITS CAUSED BY ANY USE OR INABILITY TO USE THE PRODUCT.

By using this product, YOU AGREE THAT REPAIR OR REPLACEMENT AT Cris's option will fully satisfy Cris's warranty obligation to you, whether in contract, tort negligence, strict liability or other applicable law.

To avoid malfunctions, do not drop the unit, or subject it to strong shocks. The warranty does not cover any breakage due to this type of incident. Be sure to check the grain for rocks or any foreign object. The warranty does not guarantee any breakage due to any foreign object that is passed through the mill.

SHOULD SERVICE BE REQUIRED:

1. Carefully pack the Product along with all of its accessories and other original materials in the original carton and packing materials (if still available) or in another suitable carton with sufficient protective padding to avoid injury to the Product during shipping.
2. YOU MUST ENCLOSE:
Your original packing slip or other proof of date and purchase.
Your check or money order for \$12.00, payable to CRIS ENTERPRISES, INC.
A note describing the problem that needs to be repaired.
3. Ship the Products, prepaid by Insured Parcel Post or Insured United Parcel Services (UPS) to:

CRIS ENTERPRISES, INC.
46 Old Sunbeam Dr
South Daytona Beach Fl 32119

**FAMILY FLAKER MILL
BOSCH UNIVERSAL SYSTEM
USER'S GUIDE**

The Family Flaker Mill is designed and built to give many years of service.

Before the first use, clean the flaker attachment with a dry cloth.

DO NOT USE CORN or BEANS IN THE FLAKER. THE FLAKER WAS DESIGNED TO ONLY ROLL OR FLAKE OATS, GRAINS AND SEEDS.

Use only well cleaned grain. No guarantee will be granted if repair should become necessary due to use of unclean grain, containing a lot of impurities, or because foreign bodies (metal pieces, sand, pebbles, and or plastic parts) had been milled.

Never look over the hopper while flaking. Large grain can fly out of hopper.

Cleaning - Unplug from outlet when not in use, before putting on or taking off parts and before cleaning. Always remove the attachments before disassembling or reassembling.

Never use harsh cleansers, chemicals or abrasive cleaners. Nylon and metal brushes cannot be used. Non-kitchen detergents or bleach should not be used. Do not put The Family Grain Mill attachment, or Flaker Mill attachment in the dishwasher.

IMPORTANT REMARKS:

Use only well cleaned grain to roll oats or flake grains. Hard foreign bodies such as small stones, may damage the conveyer screw on the grain mill or the knurled roller on the flaker mill. If the grain does not fall freely, grain particles may be sticking.

Avoid contacting moving parts. Keep fingers out of discharge opening or hopper. Never put a hard object in the hopper while the machine is operating.

Wipe clean with a damp cloth and dry thoroughly. The guarantee does not apply in as of damage due to inappropriate handling.

OPERATING THE FAMILY FLAKER MILL ON THE BOSCH UNIVERSAL MIXER

WHAT CAN BE FLAKED?

Any dry grains, or seeds such as Oats, wheat, rye, barley, spelt, kamut buckwheat ,millet linseed, flax seed, coriander, cumin, fennel.

CLEANING THE FLAKER MILL

From time to time, or if the Family Flaker Mill has not been used for some time, we recommend a thorough cleaning of the mill work. Clean the millwork with a dry soft brush. Do not immerse the parts in water or clean them under running water. Wipe off the parts of the housing with a damp cloth. The roller and the cone should be cleaned dry with a soft brush. NEVER PUT THE FLAKER MILL IN THE DISHWASHER.

DISMANTLING THE FLAKER MILL ATTACHMENT:

Unplug your Bosch Universal Mixer
Remove the flake mill from the Bosch Universal Mixer before dismantling the flaker mill. Remove the funnel, (6) untighten the screws (5), Remove the housing (4) pull the knurled roller (3), remove the key (2).

ASSEMBLING THE FLAKER MILL ATTACHMENT

The flaker mill must be removed from the Bosch Universal Stand Mixer before re-assembling the flaker mill.

1. Insert the key (2) into the slot that is provided in the front housing.
2. Push in the knurled roller (3).
3. Place the back housing piece against the front piece and fix it with the screws (5) 4. replace the funnel.

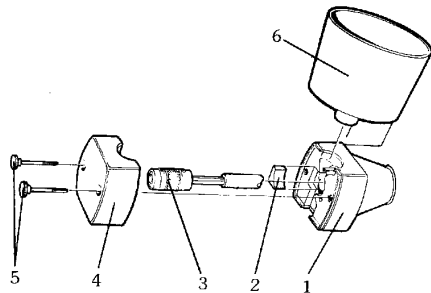

1. Housing
2. Key
3. Knurled roller
4. Housing
5. Screws
6. Funnel

MOUNTING ATTACHMENTS TO THE BOSCH UNIVERSAL STAND MIXER

1. Before attaching the grain mill or flaker mill, turn off and unplug the mixer.
2. Place the Bosch Universal Mixer on its side.
3. Insert the grain mill with the silver notch fitting into the coupling of the Bosch Universal Mixer
4. The white lever on the back of the flaker mill will lock in the mill. The lever should be pointing to 9 o'clock and must be turned clockwise until the lever has locked the flaker mill on to the mixer (pointing to 3 o'clock.)
5. Place the hopper into the opening.

REMOVING ATTACHMENTS TO THE BOSCH UNIVERSAL STAND MIXER

1. Before removing the grain mill or flaker mill, turn off and unplug the mixer.
2. Remove the hopper
3. Turn the white Lever on the back of the flaker mill from the 3 o'clock position to the 9 o'clock position
4. Remove the Flaker Mill.



FLAKER MILL

ILLUSTRATED ON BOSCH MIXER