

CRIS ENTERPRISES, INC. – FAMILY GRAIN MILL®
LIMITED WARRANTY 5 year warranty

Should any manufacturing defect be discovered, Cris Enterprises, Inc. agrees to repair or replace the defective product or part at their expense, other than handling and return freight charges, provided The Family Grain Mill® is returned with shipping charges prepaid.

This warranty is for the original purchaser and is for normal home use only. This warranty is non-transferable.

This warranty does not apply to any unit that has been tampered with or to damage incurred through negligence, misuse, faulty packing or mishandling in transit by any common carrier or by damage caused by foreign objects used before, during or after the milling process. Unclean grain sometimes will contain rock and/or metal objects, which can cause damage to your mill. Always use quality, clean grains. Never grind POPCORN.

Upon receipt of you mill and attachments inspect all attachments for parts.

Report any missing pieces within two week of receipt of mill. Cris Enterprises, Inc. will not replace any missing parts after two week of receipt of mill.

NOTE: The warranty given by CRIS DOES NOT APPLY to the appearance of any Product or to any Product which has been subjected to misuse, mishandling or service by any unapproved service person or to any Product which has been damaged, defaced, modified, altered or tampered with, whether externally or internally or to any product sold or used outside United States of America or Canada.

The **SOLE AND EXCLUSIVE REMEDY** under this warranty is **REPAIR OR REPLACEMENT AT CRIS'S OPTION** of any Product that proves to be defective in manufacture or materials within the 5 years period from the date of purchase. **TO THE FULLEST EXTENT PERMITTED BY LAW, CRIS DISCLAIMS ALL LIABILITY FOR ANY OTHER DIRECT, INCIDENTAL OR CONSEQUENTIAL DAMAGES ALLEGED TO BE CAUSED BY A DEFECTIVE PRODUCT, IE. CRIS WILL NOT BE RESPONSIBLE FOR ANY PERSONAL INJURY, PROPERTY DAMAGE OTHER THAN THE COST OF REPLACING THE PRODUCT OR ANY OTHER MONETARY DAMAGES SUCH AS LOST WAGES OR PROFITS CAUSED BY ANY USE OR INABILITY TO USE THE PRODUCT.**

By using this product, **YOU AGREE THAT REPAIR OR REPLACEMENT AT Cris's option** will fully satisfy Cris's warranty obligation to you, whether in contract, tort negligence, strict liability or other applicable law.

To avoid malfunctions, do not drop the unit, or subject it to strong shocks. The warranty does not cover any breakage due to this type of incident. Be sure to check the grain for rocks or any foreign object. The warranty does not guarantee any breakage due to any foreign object that is passed through the mill.

SHOULD SERVICE BE REQUIRED:

1. Carefully pack the Product along with all of its accessories and other original materials in the original carton and packing materials (if still available) or in another suitable carton with sufficient protective padding to avoid injury to the Product during shipping.
2. **YOU MUST ENCLOSE:**
Your original packing slip or other proof of date and purchase.
Your check or money order for \$12.00, payable to CRIS ENTERPRISES, INC.
A note describing the problem that needs to be repaired.
3. Ship the Products, prepaid by Insured Parcel Post or Insured United Parcel Services (UPS) to:
CRIS ENTERPRISES, INC.
46 Old Sunbeam Dr
South Daytona Beach Fl 32119

FAMILY GRAIN MILL® SYSTEM USER'S GUIDE

KITCHEN AID STAND MIXER

The Family Grain Mill® System is designed and built to give many years of service.

Before the first use, clean the grain mill and/or flaker attachment with a dry cloth.

Use only well cleaned grain. No guarantee will be granted if repair should become necessary due to use of unclean grain, containing a lot of impurities, or because foreign bodies (metal pieces, sand, pebbles, and or plastic parts) had been milled.

Never look over the hopper while grinding. Large grain can fly out of hopper.

Cleaning - Unplug from outlet when not in use, before putting on or taking off parts and before cleaning. Always remove the attachments before disassembling or reassembling.

Never use harsh cleansers, chemicals or abrasive cleaners. Nylon and metal brushes cannot be used. Non-kitchen detergents or bleach should not be used. Do not put The Family Grain Mill attachment, or Flaker Mill attachment in the dishwasher.

IMPORTANT REMARKS:

Use only well cleaned grain to mill or flake. Hard foreign bodies such as small stones, may damage the conveyer screw on the grain mill or the knurled roller on the flaker mill. If the grain does not fall freely, grain particles may be sticking.

Avoid contacting moving parts. Keep fingers out of discharge opening or hopper. Never put a hard object in the hopper while the machine is operating.

Wipe clean with a damp cloth and dry thoroughly. The guarantee does not apply in as of damage due to inappropriate handling.

MOUNTING AND REMOVING ATTACHMENTS TO THE KITCHENAID STAND MIXER

1. Before attaching the grain mill, flaker mill, food processor or meat grinder accessory, turn off and unplug the mixer.
2. Loosen attachment knob (1) by turning it counterclockwise Remove attachment hub cover (on some models, the cover lifts up).
3. Insert the attachment shaft housing (2) into the attachment hub (3), making certain that the attachment power shaft fits into the square hub socket.
4. Rotate the attachment back and forth if necessary to position it properly. When the attachment is in the proper position, the pin on the attachment will fit into the notch on the hub rim. Tighten the attachment knob until the attachment is completely secured to the mixer.

OPERATING THE FAMILY GRAIN MILL® ON KITCHENAID STAND MIXER

Note: Do not grind more than 10 cups of flour at one time. Allow mixer to cool at least 45 minutes before using again, or damage to the mixer may result. Use Kitchenaid stand mixer with 325 hp or higher.

Check hopper for presence of foreign objects before using.

Fill hopper with grain. Adjust the ribbed setting unit counter clockwise for the finest setting or clockwise for coarser setting.

Turn mixer to Speed 10 after grain is added. To get the finest grind, turn the knob counter clockwise past #2. Do not tighten down the knob. If grind is too fine, turn adjustment knob clockwise one click at a time until desired coarseness is obtained. Do not let the mill run without grain. This will cause excessive wear and create a loud squeaking noise.

Note: Flour ground with the Grain Mill will have a coarser texture than commercially ground flour, because commercial grinders sift out some parts of the berry before marketing the flour.

Continue to replenish grain in the hopper until the desired amount of grain is ground.

IMPORTANT NOTE: NEVER, POPCORN, LARGE OR EXTRA HARD BEANS OR PEAS SUCH AS CHICK PEAS. Do not grind oily nuts or wet wheat grains.

When using regular dried corn or any bean, crack the corn or bean on #3 on your setting unit and then regrind on the lowest setting desired. Never start grinding corn or a large bean on the lowest setting. Never turn the machine off and then turn the machine back on while whole corn or bean is in the hopper. **This WILL damage the gears in your motor base. Remove the corn or beans, clean out the grain mill.**

It is not necessary to press grain into the hopper with hands or any utensil. The moving grind worm will automatically feed the grain into the burrs.

WHAT CAN BE MILLED?

Wheat, rye, barley, spelt, kamut, buckwheat, millet, rice, oat groats, spices, dried herbs, sesame, beans and peas. Do not grind any bean, herb, grain that is oily or wet.

CLEANING THE FAMILY GRAIN MILL®

From time to time, or if the grain mill/f mill has not been used for sometime, we recommend a through cleaning of the millwork. Always remove the grain mill from the Kitchenaid stand mixer before dismantling and re-assembling the grain mill.

Clean the millwork with a dry soft brush. Do not immerse the parts in water or clean them under running water. Wipe off the parts of the housing with damp cloth. The roller and the cone should be cleaned dry with a soft brush. Clean the millwork with a soft dry brush. NEVER PUT THE grinding ring or cone in the dishwasher or let the grind ring or cone sit in water. The grinding ring and cone will rust if left standing in water.

Important: The 4-sided groove of the conveyer screw (2) should be free of all particles of flour. If not, a fine mill adjustment is not possible.

SETTING OF THE MILL GRADE:

The milling grade is set with the setting unit (2). To grind flour turn ribbed knob on the setting unit counter clockwise until the desired setting. To a grind coarser grind turn the ribbed knob clockwise.

Do not turn the setting unit past stop. This will disengage to grinding cone and the wheat berries will fall through. If this should happen do the following:

TO RE-ENGAGE THE UNIT, place two fingers behind the lock ring (#6), turn the ribbed knob on the setting unit (#5) clockwise until it passes the stop line. Continue holding the mill attachment, place your thumb on the front button of the setting unit. While pressing gently on the front button, turn the ribbed knob counter-clockwise to re-engage the mill.

DISMANTLING THE GRAIN MILL:

Remove the grain mill from the Kitchenaid Stand Mixer before dismantling the grain mill. Remove funnel (7) Turn lock ring (6) counter clockwise. Remove the setting unit (5) Remove the steel conical mill work (pieces 4 & 3) and the conveyer screw (2)

ASSEMBLING THE GRAIN MILL

The grain mill must be removed from the Kitchenaid Stand Mixer before re-assembling the grain mill

1. Place the conveyer screw (2) in the housing (1).
2. Set the steel grinding ring (3) in the housing (1). **Note: Check the two flat sides of the steel ring are seated firmly onto the housing (1).**
3. Insert the 4 sided steel cone (4) into the conveyer screw (2).
4. Place the setting unit (5) so the groove on the setting drum is opposite the snap-in nose on the housing.
5. Screw the lock ring (6) clockwise tightly with the housing.

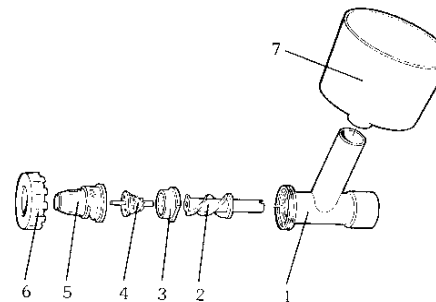

1. Housing
2. Conveyer Screw
3. Grinding ring
4. Grinding cone
5. Setting unit
6. Lock ring
7. Funnel